



**MUSIC CITY
PrEP CLINIC**

SPECIMEN COLLECTION INSTRUCTIONS

POWERED BY
MOLECULAR[®]
TESTING LABS

WATCH THE VIDEO

We recommend you watch this online video
to make the collection process easier.



www.musiccityprep.org/testing

BEFORE YOU BEGIN

1. Read all instructions thoroughly before collecting your specimens.
2. Your kit may not contain all collection devices in the following instructions. Please only use and follow the instructions for the collection devices provided in your kit.
3. Blood card collection instructions are included with the blood collection kit.
4. Do not eat, drink, smoke or brush your teeth for 30 minutes prior to collection of the oral swab specimen.
5. Do not drink alcohol on the day of collection.
6. Do not collect specimens while taking antibiotics. Wait at least 7 days after you have taken your last dose.
7. Collection tubes may contain a liquid preservative. DO NOT EMPTY LIQUID PRESERVATIVE FROM THE COLLECTION TUBES.

**Need Help? Call Music City PrEP's Homekit Hotline at:
(615) 800-7822**

ORAL SWAB

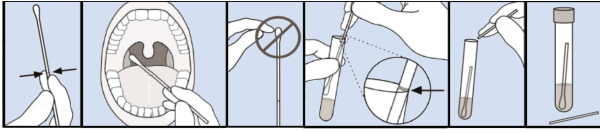

1. Hold the oral swab so the score line is above your hand.
2. Insert the oral swab into your mouth and rub swab tip against the back of your throat for 10 seconds.
3. Carefully withdraw the oral swab and place into the collection tube marked "Oral." Break the swab at the score line by bending it against the collection tube.
4. Place lid onto the collection tube and ensure that it is closed evenly and tightly.
5. Write your date of birth in MM/DD/YYYY format onto the tube in the designated area labeled "DOB."
6. Write today's date in MM/DD/YYYY format onto the tube in the designated area labeled "Collection Date."
7. Place specimen into one of the empty biohazard bags and ensure the seal is closed completely.

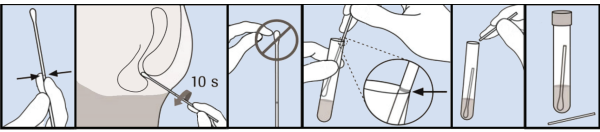

1. Hold the anal swab so the score line is above your hand.
2. Insert the anal swab 1 to 2 inches into the anus.
3. Gently turn the anal swab for 5 to 10 seconds while rubbing the swab against the walls of the rectum.
4. Carefully withdraw the anal swab and place into the collection tube marked "Anal." Break the swab at the score line by bending it against the collection tube.
5. Place lid onto the collection tube and ensure that it is closed evenly and tightly.
6. Write your date of birth in MM/DD/YYYY format onto the tube in the designated area labeled "DOB."
7. Write today's date in MM/DD/YYYY format onto the tube in the designated area labeled "Collection Date."
8. Place specimen into one of the empty biohazard bags and ensure the seal is closed completely.

URINE

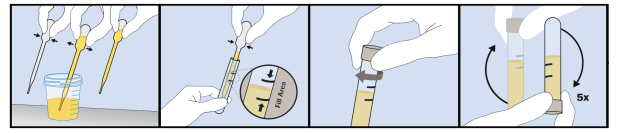

1. Do not urinate for at least 1 hour prior to collection. First morning urine is best.
2. Urinate directly into the collection cup and collect 30 ml to 50 ml of urine.
3. Use the pipette to transfer urine from the collection cup into the collection tube(s) marked "Urine."
4. Fill the collection tube(s) until the combined liquid is between the designated fill lines. **Do not fill tube past the maximum fill line or specimen will be rejected.**
5. Place lid onto the collection tube(s) and ensure that it is closed evenly and tightly.
6. Write your date of birth in MM/DD/YYYY format onto the tube in the designated area labeled "DOB."
7. Write today's date in MM/DD/YYYY format onto the tube in the designated area labeled "Collection Date."
8. Place specimen into one of the empty biohazard bags and ensure the seal is closed completely.

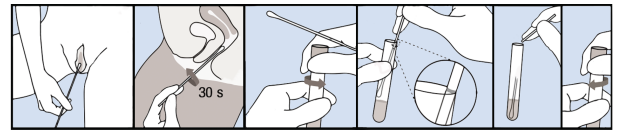

1. Hold the vaginal swab in one hand and separate the labia (folds of skin around the vaginal opening).
2. Insert the swab 2 inches into the vaginal opening.
3. Gently turn the swab for 30 seconds while rubbing the swab against the walls of the vagina.
4. Carefully withdraw the swab and place into the collection tube marked "Vaginal." Break the swab at the score line by bending it against the collection tube.
5. Place lid onto the collection tube and ensure that it is closed evenly and tightly.
6. Write your date of birth in MM/DD/YYYY format onto the tube in the designated area labeled "DOB."
7. Write today's date in MM/DD/YYYY format onto the tube in the designated area labeled "Collection Date."
8. Place specimen into one of the empty biohazard bags and ensure the seal is closed completely.

ANAL SWAB

VAGINAL SWAB

SHIPPING CHECKLIST

- Have you used all collection devices contained in the kit to collect the required specimens?
- Is your date of birth written on all specimen collection tubes and the blood card using MM/DD/YYYY format?
- Is the collection date written on all specimen collection tubes and the blood card using MM/DD/YYYY format?
- If a blood card is contained in your kit, are the circles completely filled with blood and soaked through the collection card?
- Is each specimen collection tube and the blood card sealed in a biohazard bag?
- Are all specimens placed into the box?
- Is the box placed into the pre-paid return shipping bag?
- Is the return shipping bag completely sealed?

FedEx INSTRUCTIONS

Step 1: Call FedEx at 1-800-GoFedEx (1-800-463-3339) to request a "FedEx Express return pickup."

Step 2: Provide FedEx customer service agent with additional information as requested.

Step 3: If a credit card or account number is requested, tell them that this is a "FedEx return pickup" and provide them with tracking number on the return label and no payment will be required.

Or, visit [fedex.com](https://www.fedex.com) to find a local drop off location near you

SHIPPING